

Plant No	
-----------------	--

Description	Airport and Road-plate Lifter
--------------------	--------------------------------------

Serial No	
------------------	--

Contract number & Customer Name	
--	--

New		Pre Hire		Thorough Examination		Off Hire Test	
------------	--	-----------------	--	-----------------------------	--	----------------------	--

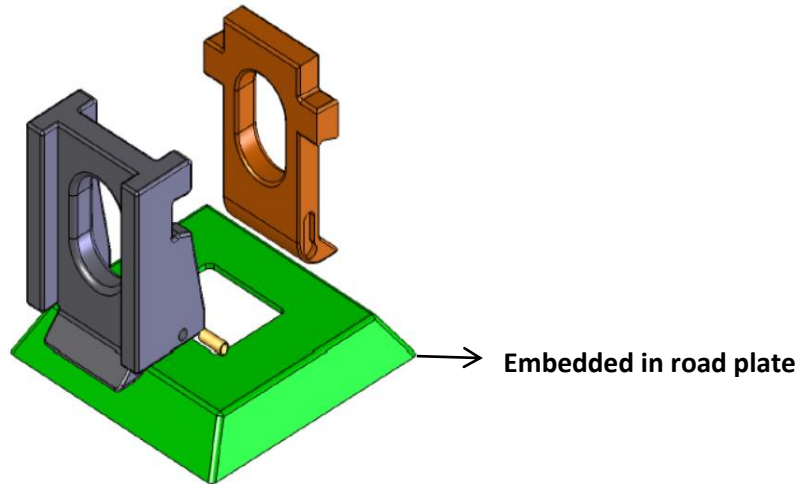

Examination Area/ Instructions	Comments/Measurements	Pass	Fail
Check and record that the unique serial/plant number is stamped on the side of lifter. Make sure CE mark legible.			
Clean the device for any foreign debris and lubricate the lifter when necessary for smooth operation.			
Make sure the lifter does not show any sign of abuse.			
Check the device and use the above drawing to indicate any sharp edges, sign of wear, damage, distortion or security concern. Check also where the shackle & hook will cause wear & tear top part lifting eye.			
Check for damage, security concern (stress) on the ankle part of tool and make sure it is not pinched.			
Check that the 2 x roll pins are in place, not bent and undamaged.			
Lift test operation of the lifter device with appropriate road plate.			
The results of all hire inspection must be entered onto the computer system			

Equipment which displays evidence of incorrect operation should be withdrawn from service

Equipment should be cleaned and correctly stored after checking

Print Name Checked by:

Signature:

Date:

Welded anchors plates must be examined, pre & post hire and results recorded on the Day Sheet. These lifting points are considered part of the load so must be inspected by the operator prior to each lift.